

GROUND FLOOR  
APPROX. FLOOR  
AREA 397 SQ.FT.  
(36.9 SQ.M.)

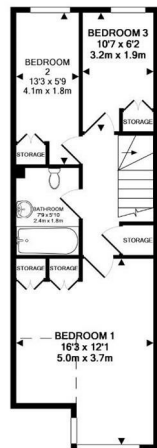

1ST FLOOR  
APPROX. FLOOR  
AREA 433 SQ.FT.  
(40.3 SQ.M.)



22 Park Meadow, Doddinghurst, Brentwood, CM15 0TT

Three bedroom terrace house which has views over a pleasant green. The property features an easy to maintain garden of 40' with artificial grass and well stocked flower beds and a detached garage in a block to the rear with parking in front.

Guide Price £359,000

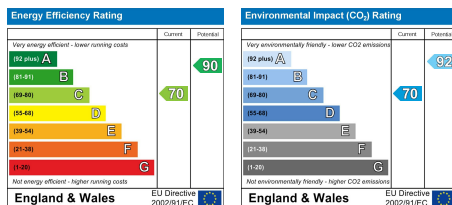

#### SERVICES:

Local Authority: Brentwood  
Council tax band:  
Post code: CM15 0TT

#### VIEWING:

Strictly by prior arrangement with Keith Ashton Estate Agents

#### OPENING HOURS:

Monday to Friday: 8.45AM - 6.30PM | Saturdays: 9AM - 5.30PM | Sundays: 10AM - 2PM

#### MORTGAGE INFORMATION:

We offer the additional facility of an in-house Independent Financial Adviser who will access all mortgage lenders with the purpose of providing you with the benefit of choice. For quotations or comparables please call 01277 375757 or visit our interactive website at [www.mortgagebusiness.net](http://www.mortgagebusiness.net)



WE THE AGENT HAVE NOT TESTED ANY APPARATUS, FITTINGS OR SERVICES FOR THIS PROPERTY. THE PLOT SIZE IS INTENDED MERELY AS A GUIDE AND HAS NOT BEEN OFFICIAL MEASURED OR VERIFIED BY THE AGENT. PHOTOGRAPHS ARE FOR ILLUSTRATION ONLY AND MAY DEPICT ITEMS WHICH ARE NOT FOR SALE OR INCLUDED IN THE SALE OF THE PROPERTY.

Brentwood  
Tel. 01277 260858

Village Office  
Tel. 01277 375757

Lettings Office  
Tel. 01277 202200

Explore more @ [www.keithashton.co.uk](http://www.keithashton.co.uk)

